



R-23



The popular Ranger Tugs R-23 is powered by a 200 HP outboard. The first thing you will notice when looking at the R-23 is the dramatic, curved windshield and visor, which is emphasized by several overhead skylights. There is no shortage of light or visibility on board the R-23, which incorporates four opening roof hatches, sliding side windows, and an opening rear glass bulkhead, providing a very open and airy feeling inside. Opening portlights also allow for a nice cross breeze in the cabin.

The forward cabin on the R-23 has plenty of room for sitting around the teak table, separate sleeping for two, or sleeping two together with the filler-cushion. The mid berth is great for kids or storage, and the dinette converts to a sleeper as the third berth. The well-appointed galley on the R-23 is standard with refrigerator/freezer, cooktop, and microwave. The forward head includes a marine toilet with holding tank, shower, sink, and mirror. The Ranger Tugs R-23 is equipped with a Garmin 942xs GPS chartplotter sonar combo and is available with optional xHD radar. VHF to stay in touch, illuminated compass, cabin night light, cockpit and exterior side trail lighting, and our built-in safety trailering lights (brake, turn, and reverse) are all standard equipment making the R-23 ready to cruise. The cockpit on the R-23 is always ready to entertain and built to fish with standard rod holders, optional downrigger pads & outlets, and two comfortable fold out seats.

The R-23 is ideal for overnighting or extended cruising. It incorporates many of the same amenities as a larger cruising yacht that until now were not offered on a boat of her size and price point. Whether you are new to boating or a seasoned captain, you'll enjoy countless hours of fun and adventure aboard your R-23.

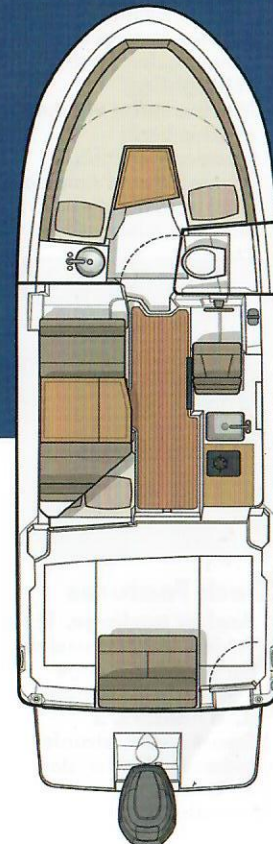

R-23 Specifications

Length rigged LOA (motor down)	28' 5"	8.7 m
Length rigged LOA (motor up)	29' 8"	9 m
Beam	8' 6"	2.5 m
Draft (motor down)	30"	0.76 m
Draft (motor up)	19"	0.48 m
Height on factory trailer (w/radar)	11' 6"	3.5 m
Height on factory trailer (no radar)	10' 10"	3.3 m
Length on factory trailer	36' 0"	11 m
Weight, dry	6,000 lbs	2,722 kg
Bridge clearance (mast down)	8' 6"	2.5 m
Fuel capacity	80 U.S. Gal	302.8 L
Water capacity	22 U.S. Gal	83.3 L
Holding tank capacity	11 U.S. Gal	41.6 L

